

SECTION A - FIXING OF TWO HALVES OF GRATE

(REFER TO 705.01)

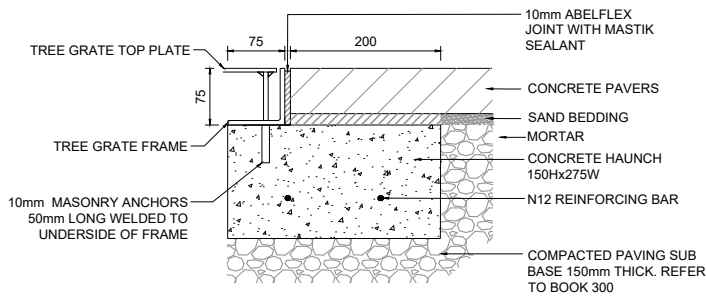

SECTION B - STANDARD TREE GRATE FIXING IN CONCRETE PAVERS

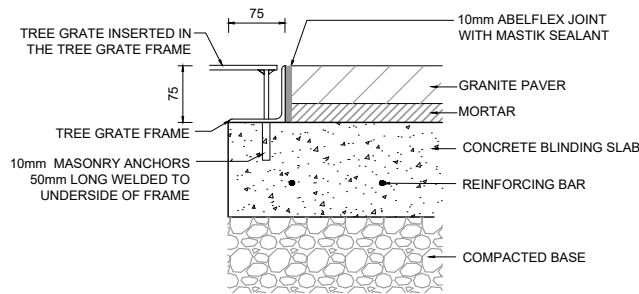

SECTION B - STANDARD TREE GRATE FIXING IN GRANITE PAVING

NOTES

1. REFER TO BOOK 300 FOR CONCRETE PAVING SPECIFICATION AND DETAILS.
2. REFER TO BOOK 1000 FOR GRANITE PAVING SPECIFICATION AND DETAILS.