

City of Perth

Design and Construction Note

401.01

Standard Kerb Types and Installation Details

Granite Kerb Types

Reviewed: 17/10/2018

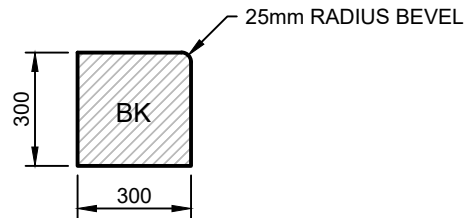
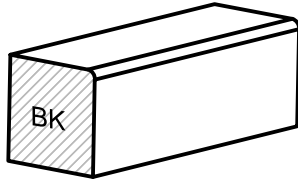

BARRIER KERB

- LENGTH VARIES: 800-1200mm

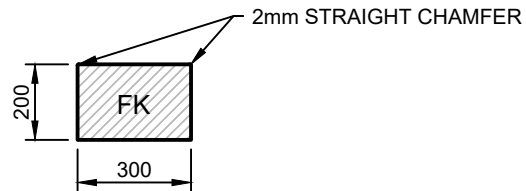
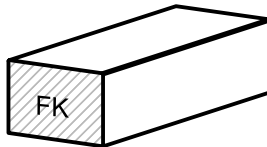

FLUSH KERB

- LENGTH VARIES: 800-1200mm

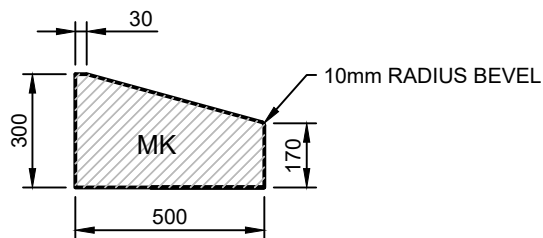
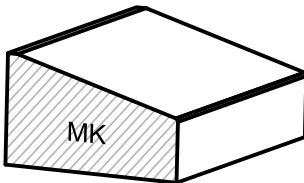

MOUNTABLE KERB

- LENGTH VARIES: 800-1200mm

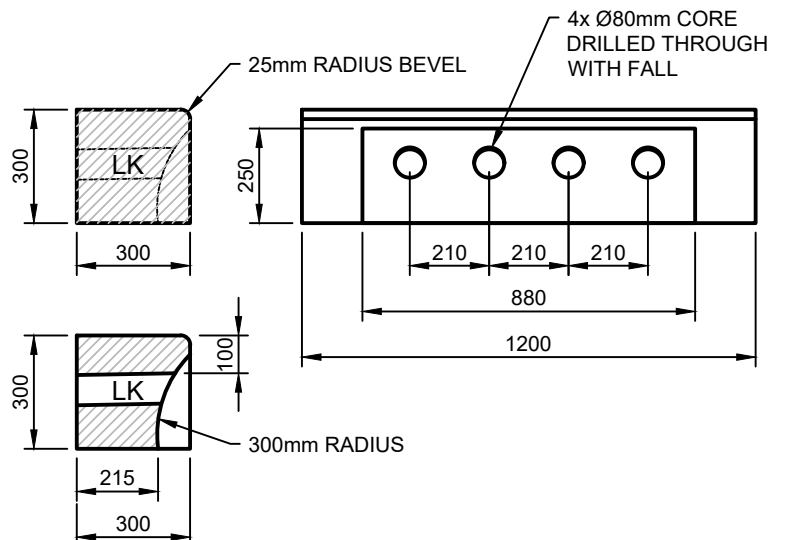
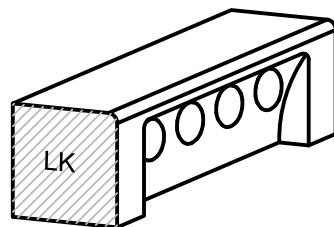

LINTEL KERB

- LENGTH: 1200mm